

Perma-mount™ ball valve lockout

These Lockout Devices keep your critical valves ready for correct lockout. Retrofit lockout devices stay permanently in place at the point of need.

- Eliminate the need to choose and carry the correct devices for each lockout event
- Securely retain the operating handle in the 90° fully-closed position
- Two sizes fit the full range of 1 to 10 cm diameter ball valves
- Designed to withstand a wide range of environmental conditions



Consult the technical datasheet LOTO-74 on bradyeurope.com/tds



Order Reference	Description	Material	Width (mm)	Height (mm)	Quantity
121541	Perma-mount™ Ball Valve Lockout, Large size	Metal	162.81	92.20	1
121540	Perma-mount™ Ball Valve Lockout, Small size	Metal	108.20	55.88	1

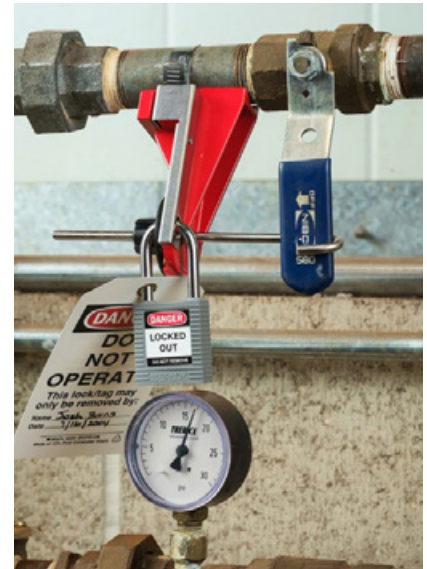

Ball valve lockout

Versatile and easy-to-use device. The two halves of the device encompass the ball valve lever to secure it from inadvertent activation of the valve.

- Small device: locks out pipes from 12.70 - 31.75 mm in open and 12.70 - 63.50 mm closed position.
- Large device: locks out pipes 50.80 to 203.20 mm
- Versatile and easy-to-use
- Made from Ultra-tough Polypropylene
- Service temperature from -20 °C to 80 °C



Consult the technical datasheet LOTO-22 on bradyeurope.com/tds

Watch the video



Order Reference	Colour	Fits Pipe Sizes (mm)	Max. Shackle Diameter (mm)	Min. Shackle Clearance (mm)	Quantity
Small					
800110*	Red	12.70 - 63.50	7.95	19.05	1
805847	Blue	12.70 - 63.50	7.95	19.05	1
805848	Green	12.70 - 63.50	7.95	19.05	1
805849	Yellow	12.70 - 63.50	7.95	19.05	1
Large					
800111	Red	50.00 - 200.00	7.24	38.00	1
805850	Blue	50.80 - 203.20	7.24	19.05	1
805851	Green	50.80 - 203.20	7.24	19.05	1
805852	Yellow	50.80 - 203.20	7.24	19.05	1

*This product meets the ATEX Equipment Directive.

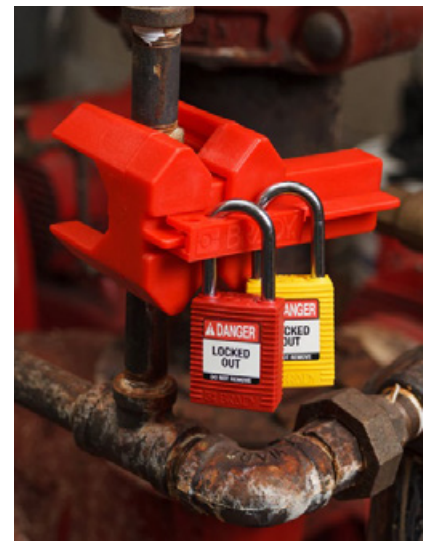

T-handle Ball Valve Lockout



This single piece lockout device has an adjustable design that provides a secure fit when locking out T-handle ball valves on PVC pipes.

- Fits most T-handle valves on PVC pipes 12.70 to 50.80 mm in diameter
- Exclusive design features adjustable slides to ensure proper fit
- Easy to apply, lock and store

Order Reference	Description	Material	Size valve lever (mm)	Fits Pipe Sizes (mm)	Max. Shackle Diameter (mm)	Min. Shackle Clearance (mm)	Quantity
151748	T-handle Ball Valve Lockout - Small	ABS	31.00 - 40.00	12.70 - 25.40	7.10	20.00	1
151749	T-handle Ball Valve Lockout - Large	ABS	31.00 - 57.00	31.75 - 50.80	7.10	20.00	1

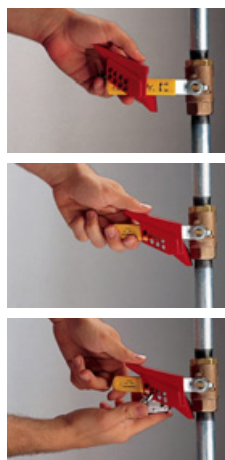

Brady ball valve lockout

Brady ball valve lockouts are the ideal tool for securing your quarter-turn angled ball valves in the OFF position.

- Fits virtually any valve lever up to 76 mm
- Available in 2 sizes
- Service Temperature from -30 °C to 120 °C

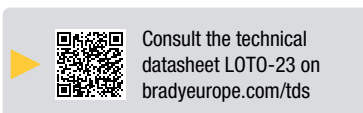

Order Reference	Description	Material	Max. Handle Thickness (mm)	Max. Valve Handle Width (mm)	Size valve lever (mm)	Max. Shackle Diameter (mm)	Min. Shackle Clearance (mm)	# of Holes	Quantity
065666*	Small Brady Ball Valve Lockout	Nylon	19.05	38.10	6.35 - 25.40	7.16	19.05	8	1
065692	Small Brady Ball Valve Lockout	Steel	19.05	38.10	6.35 - 25.40	9.53	19.05	6	1
065669	Large Brady Ball Valve Lockout	Steel	10.92	53.34	31.75 - 76.20	7.16	19.05	8	1
065693	Large Brady Ball Valve Lockout	Steel	10.92	53.34	31.75 - 76.20	9.53	19.05	7	1

*This product meets the ATEX Equipment Directive.